



# 6010-2Z Deep groove ball bearings

- Popular item  
- SKF Explorer

## Deep groove ball bearings

### Bearing data

[Tolerances](#),

Normal (metric), P6, P5, Normal (inch),

[Radial internal clearance](#),

Matched bearing pairs, Stainless steel  
 $d < 10$  mm, Other bearings

### Bearing interfaces

[Seat tolerances for standard conditions](#),

[Tolerances and resultant fits](#)

## Technical specification

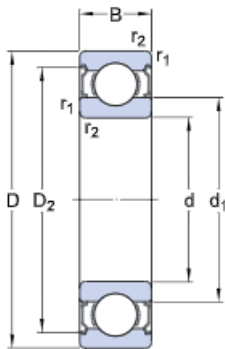

### DIMENSIONS

d	50 mm	Bore diameter
D	80 mm	Outside diameter
B	16 mm	Width
$d_1$	≈ 59.75 mm	Shoulder diameter
$D_2$	≈ 72.8 mm	Recess diameter
$r_{1,2}$	min. 1 mm	Chamfer dimension

### ABUTMENT DIMENSIONS

$d_{\xi}$ min.	54.6 mm	Diameter of shaft abutment
$d_{\xi}$ max.	59.7 mm	Diameter of shaft abutment
$D_{\xi}$ max.	75.4 mm	Diameter of housing abutment
$r_a$ max.	1 mm	Radius of shaft or housing fillet

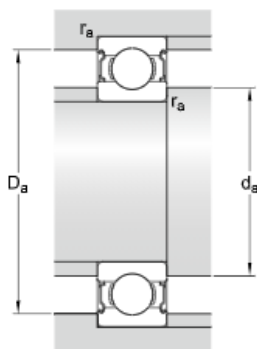

## CALCULATION DATA

C	22.9 kN	Basic dynamic load rating
C <sub>0</sub>	15.6 kN	Basic static load rating
P <sub>u</sub>	0.71 kN	Fatigue load limit
	18 000 r/min	Reference speed
	9 000 r/min	Limiting speed
k <sub>r</sub>	0.025	Minimum load factor
f <sub>0</sub>	14.7	Calculation factor

## MASS

	0.27 kg	Mass bearing
--	---------	--------------

## TOLERANCE CLASS

P6		Dimensional tolerances
P6		Radial run-out